

Cooling for up to 40 hours wire-free

Designed for absolute portability, GLACIER can be powered by the Plug-in Battery and free from messy, limiting cables. With a large battery capacity of 298Wh, savour up to 40 hours. With 100W max USB-C charging, it even powers up your phones and laptops.



A fridge-freezer at its best

Equipped with a removable divider separating it into two zones, and independent temperature control, both sections can refrigerate and freeze from 50°F (10°C) to -13°F (-25°C). Whatever you want to stock up on, it shape-shifts to meet your needs.



*Cooling at the optimum speed when empty

EcoFlow GLACIER

EcoFlow GLACIER is the world's first 3-in-1 portable fridge, freezer, and ice maker. Enjoy ice-cold drinks and fresh food when you're on the road, boat, lorry, camping, or off-grid.



"The Best Portable Appliance "

By Popular Mechanics



GLACIER

Get Chillin. Get Movin.



Industry's first integrated ice maker

Equipped with a powerful 120W compressor, it brings you 18 solid ice cubes in 12 minutes. For all the spine-tingling moments along your journey, spice them up with chilled fizzy drinks.

*This result was achieved with an ambient temperature of 77°F (25°C) and a water temperature of 59°F (15°C). The first round of ice-making may take longer than 12 minutes.

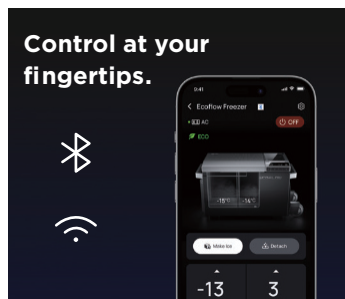

Scenarios



Specifications

General information

Net Weight
23 kg (50.7 lb)

Dimensions (wheels and handles not included)
776 mm × 385 mm × 445 mm (30.6 in. × 15.2 in. × 17.5 in.)

IP Rating IPX4 **App Control** Bluetooth, Wi-Fi

Refrigeration Temperature Range
-25°C to 10°C (-13°F-50°F) (ambient temperature at 25°C)

Noise Level (stable operation)
Ice making: <52 dB; Refrigeration: <42 dB

Refrigerant type/Amount
R600a, 32 g

Quick Freezing Mode
Refrigerate from 30°C (86°F) to 0°C (32°F) in 15 minutes

Refrigeration Power Rating
120W

Input

AC Input
100-240V, 50/60Hz, 180W

Car Charging Input
96W/192W (12/24V, 8A Max)

Solar Charging Input
240W (11-60V, 13A Max)

Battery Pack Power
100W (USB-C)

Operating temperatures

Optimal Operating Temperature
-20°C (-4°F) to 50°C (122°F)

Optimal Storage Temperature
-20°C (-4°F) to 60°C (140°F)

EcoFlow GLACIER Plug-in Battery

Net weight
1.8 kg (4 lb)

Dimensions
245.5 mm × 92 mm × 68 mm
(9.7 in. × 3.6 in. × 2.7 in.)

Cycle life
800 cycles to 80%

Capacity
298Wh